

# SUBJECT TO MODIFICATION(S)

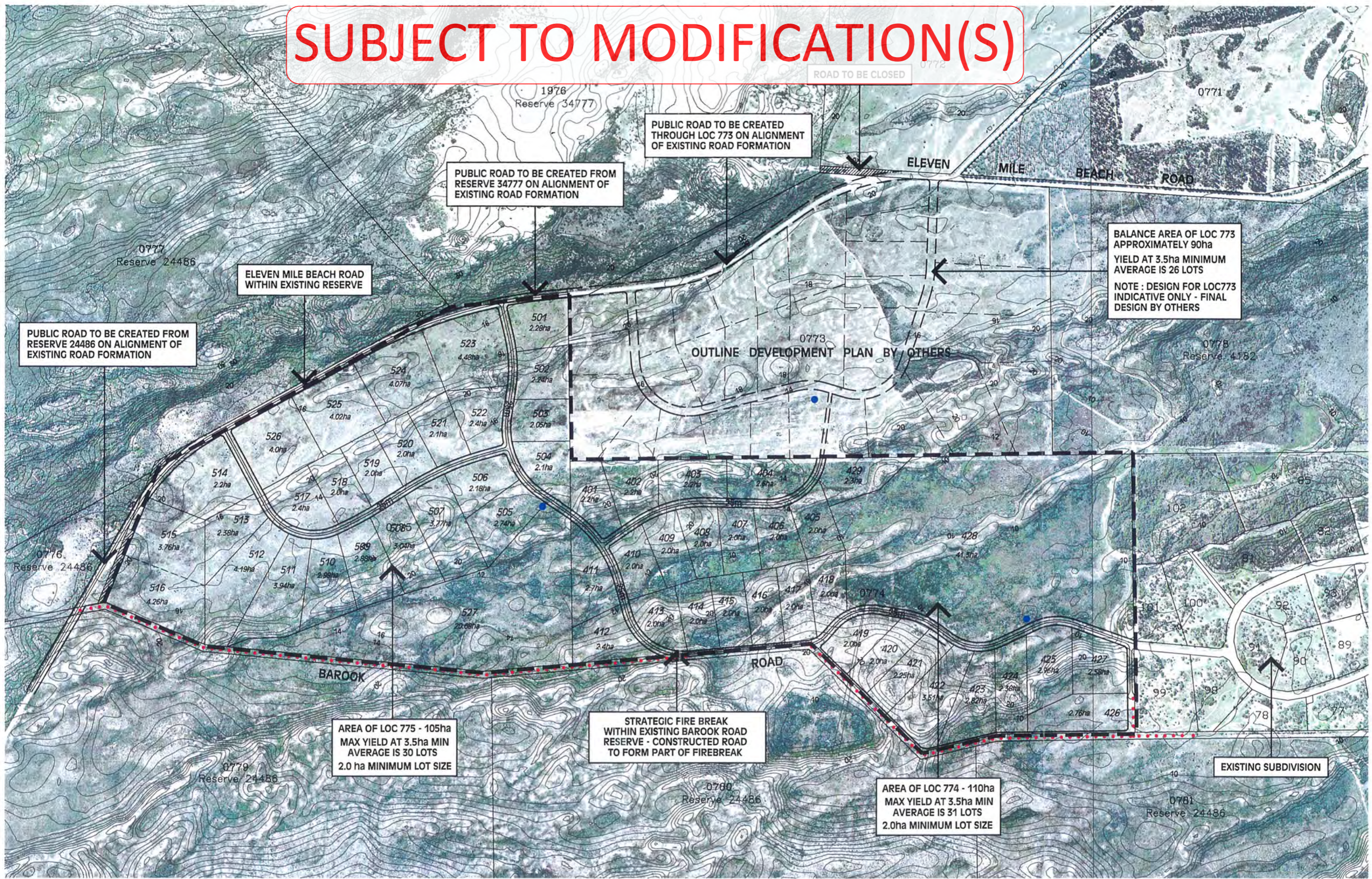

**OUTLINE DEVELOPMENT PLAN - FIG.5**  
 LOCATIONS 773, 774 AND 775  
 ELEVEN MILE BEACH ROAD, ESPERANCE

**NOTES**  
 Distances and areas subject to survey

- LEGEND**
- Static water supply (excavation and hardstand) for fire fighting purposes.
  - - - - - Strategic fire break

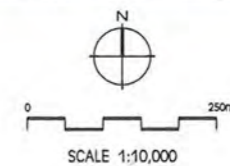

**GRAY & LEWIS**  
 LAND USE PLANNERS  
 URBAN DESIGNERS &  
 PROJECT MANAGERS  
 2 Hardy Street, South Perth, WA, 6151  
 Tel (08) 9474 1722 Fax (08) 9474 1172  
 perth@graylewis.com.au